



# MD Series

## SMD Low Profile High Current Molded Inductor

### Size 1040

#### CHARACTERISTICS

- Molded type
- High saturation current due to CIP material
- Nature air gap and no acoustic noise Different sizes available
- LC filter
- Quantity: 500pcs

#### APPLICATION

- 
- 

#### Dimensions: [mm]

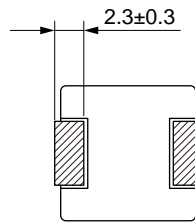
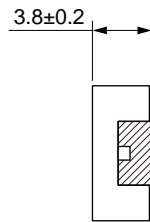
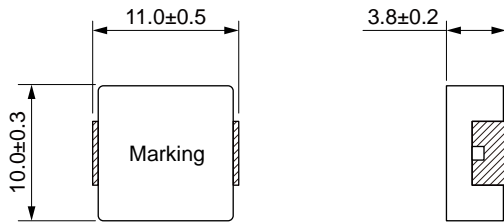

#### Land Pattern: [mm]

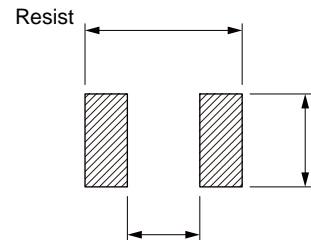

#### Electrical Properties:

				Saturation		
MD1040-R15N	0.15	±30%	43.0	75.0	0.50	0.60
MD1040-R22M	0.22	±20%	35.0	60.0	0.80	1.00
MD1040-R33M	0.33	±20%	31.0	60.0	1.00	1.20
MD1040-R36M	0.36	±20%	31.0	60.0	1.05	1.20
MD1040-R47M	0.47	±20%	28.0	43.0	1.30	1.50
MD1040-R56M	0.56	±20%	25.0	40.0	1.60	1.80
MD1040-R68M	0.68	±20%	22.0	39.0	2.40	2.70
MD1040-1R0M	1.00	±20%	18.0	36.0	3.00	3.30
MD1040-1R5M	1.50	±20%	16.0	33.0	4.00	4.60
MD1040-2R2M	2.20	±20%	12.0	27.0	6.50	7.00
MD1040-3R3M	3.30	±20%	11.0	20.0	10.8	11.8
MD1040-4R7M	4.70	±20%	10.0	17.0	15.0	15.5
MD1040-5R6M	5.60	±20%	9.00	14.0	17.0	19.3
MD1040-6R8M	6.80	±20%	8.50	13.5	17.5	23.3
MD1040-8R2M	8.20	±20%	8.00	12.5	20.0	22.5
MD1040-100M	10.0	±20%	7.50	12.0	27.0	30.0



Typical Electrical Characteristics:

